

**S-CAN 3D Ltd.**

Unit 10b  
Bunn's Bank Ind Est,  
Attleborough  
Norfolk  
UK  
NR17 1QD

Tel +44 (0)1953 857800  
Email info@atpowerthrottles.com  
Web www.atpower.com



# Fuel Rails and Fittings

DATASHEET REV001 6.25  
EXTRACTED FROM THROTTLE TERMINOLOGY

If you need to change AT Power's fuel rail fittings, contact us with your serial number and we will advise accordingly. Do **not** remove the end fittings yourself, as this will cause damage and will void your warranty.

AT Power's Standard:  
Fuel Rail Fitting - AN6

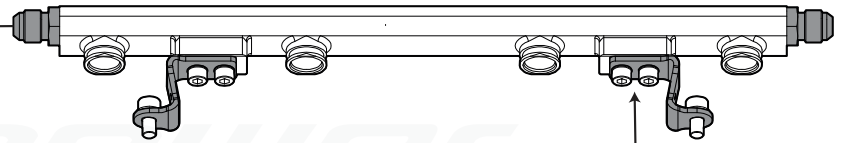

Injector Brackets

## Fuel Rail Fitting Options

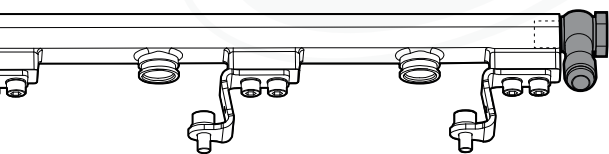

Banjo fitting available  
for tighter engine spaces

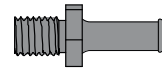

Optional 8mm  
hosetail fitting

## Injector Brackets - Standard Options

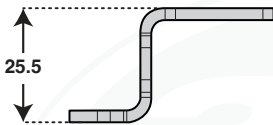

25.5

Suits Bosch EV14 Short  
Part 102-211-00204

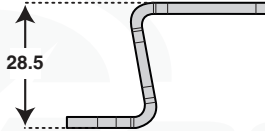

28.5

Suits Pico's  
Part 102-211-00064

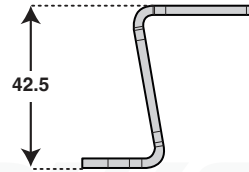

42.5

Suits Bosch EV14 Standard  
& EV12 Injectors  
Part 102-211-00286

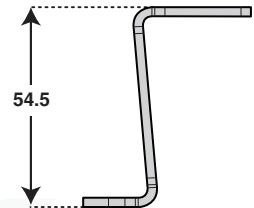

54.5

Suits Bosch EV14 Long  
& EV6 Injectors  
Part 102-211-00287

## Example of Secondary Fuel Injection

Get in touch with AT Power if you require Secondary Fuel Injection rails.

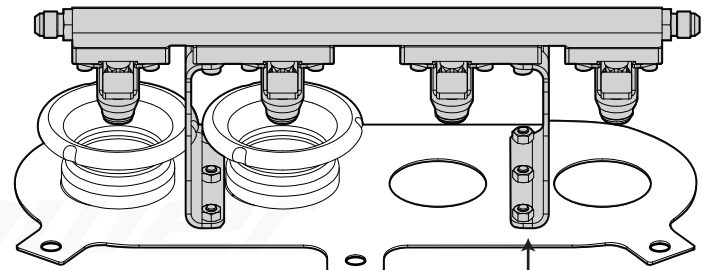
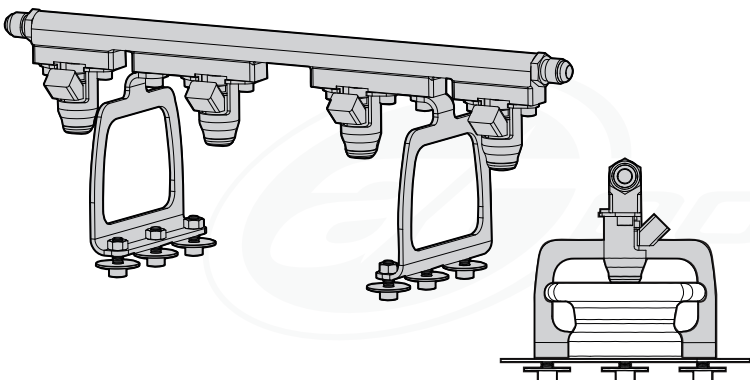

Mounts onto Backplate  
Not supplied drilled

