

# Oil Pump Pulley Attachment

---

Before starting make sure your pulley and the crankshaft pulley are properly aligned. This is essential for smooth operation - if they're misaligned, the timing belt may slip off or come loose during use.

## Parts Required

---

- A. Keyway
- B. Oil Pump Nose
- C. Threadlocker Glue (not pictured)
- D. Oil Pump Pulley Wheel
- E. 3 Holed Locking Washer
- F. 2 x M5 Screws
- G. 2 x M5 Flat Washers
- H. M6 Screw

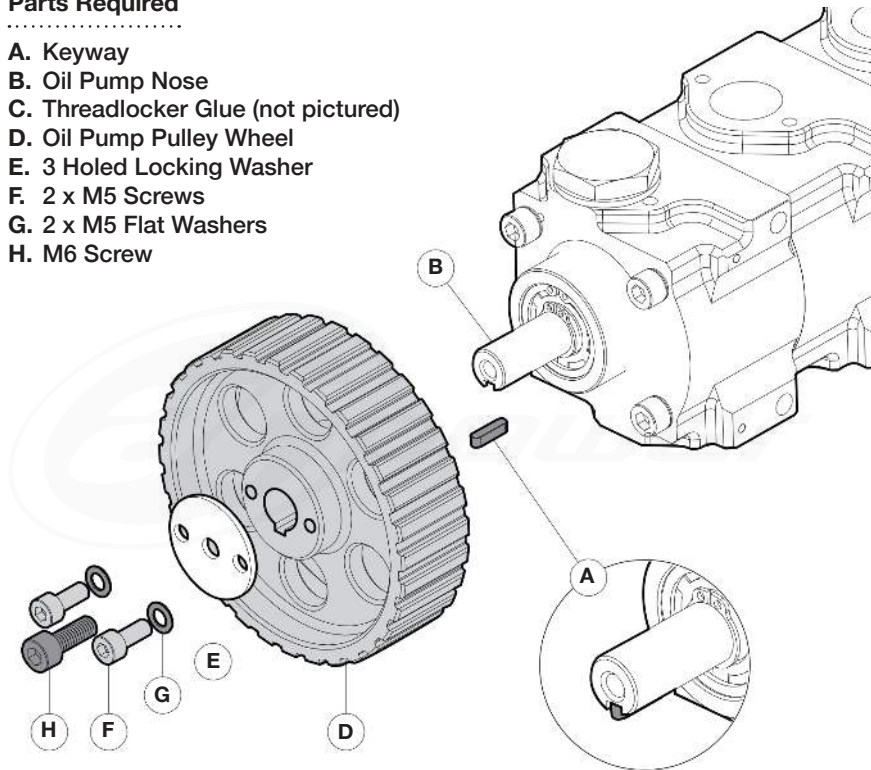

1. Attach the keyway (A) into the oil pump nose (B). Ensure it's securely in place before proceeding with Threadlocker Glue (C).

2. Position the pulley (D) onto the oil pump nose, making sure the keyway is properly aligned into the notch on the pulley. Place the locking washer (E) over the pulley, then secure it using 2 x M5 screws (F) with flat washers (G). Apply threadlocker glue to the screws before tightening them to a torque of 8–10 Nm.

3. Insert the M6 screw (H) to secure the center and use threadlocker glue to lock it in place. Torque it to 10–12 Nm whilst the glue has not yet set.

You're now ready to attach the timing belt. For compatible timing belts and further information, please visit our website.