

RIGHT SIDE (TPS)

LEFT SIDE

AN-6 MALE FITTINGS BOTH ENDS FUEL RAIL BRACKETS TO SUITE PICO INJECTORS

MEGAFLOW AIR FILTER SOLD SEPARATLY JC50/S65 PART No. 102-108-00039

RIGHT SIDE

LEFT SIDE

TPS OPTIONS AVAILABLE

RIGHT SIDE

LEFT SIDE

8 x Ø 9 THRU ALL

RIGHT PULL CABLE LINKAGE AND IDLE ADJUSTMENT

1/8" BSP VACUUM TAKE OFFS AVAILABLE DRILL 4MM HOLE THROUGH IF REQUIRED

SECTION A-A

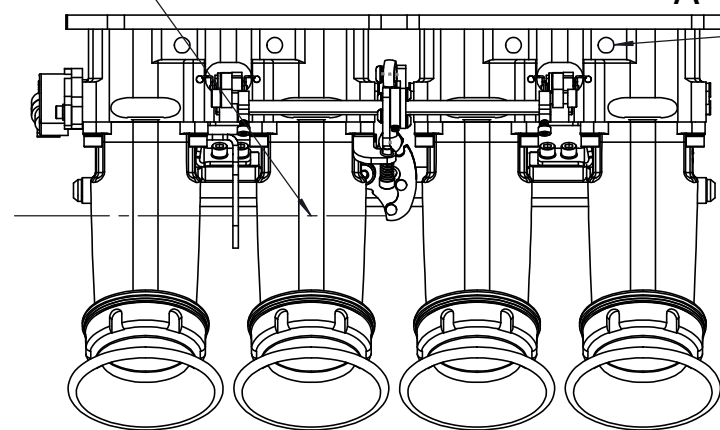
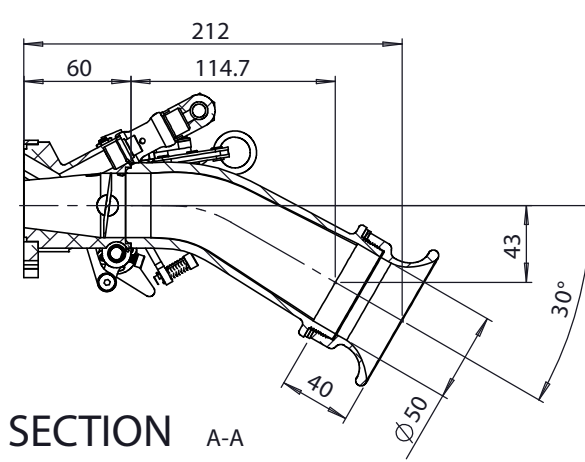
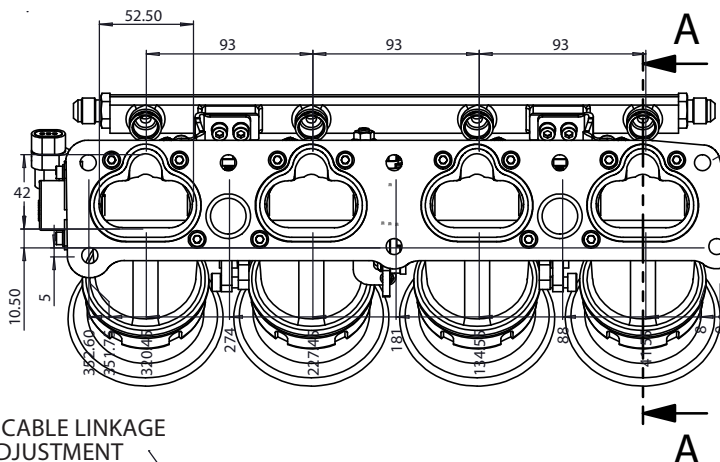

alpower

S-CAN 3D Ltd
Bunns Bank Ind Est
Attleborough NR17 1QD

THIRD ANGLE PROJECTION

SCALE 1:3	WEIGHT 3.142 kg
DRAWN -	S.HOW
DATE -	30/09/25
CHECKED -	S.HOW
APPROVED -	S.HOW

MATERIAL	SEE COMPONENT PARTS
FINISH	SEE COMPONENT PARTS
DRAWING TITLE	ASSY - PEUGEOT 206 GTI 45MM - PRE-CONFIGURED
DRAWING NUMBER	102-102-00621

UNLESS OTHERWISE STATED:
DIMENSIONS IN MILLIMETRES
TOLERANCES: LINEAR ±0.1 ANGULAR ±0.5°
SURFACE FINISH ✓ = ✓
DRAWING STANDARDS TO ATQS 6003
DATE FORMAT: DD/MM/YY

THIS DESIGN IS THE PROPERTY OF S-CAN 3D LTD AND MUST NOT BE REPRODUCED OR COMMUNICATED WITHOUT AUTHORITY

CAD PLOT DO NOT SCALE