

S-CAN 3D Ltd
Bunns Bank Ind Est
Atleborough NR17 1QD

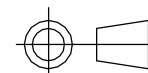

THIRD ANGLE PROJECTION

SCALE
1:2

WEIGHT
3.3 kg

DRAWN - S.HOW

DATE - 21/04/22

CHECKED - S.HOW

APPROVED - A.CLIFTON

MATERIAL

SEE COMPONENT PARTS

FINISH

SEE COMPONENT PARTS

DRAWING TITLE

ASSY - HOUSING - UNIVERSAL -
HONDA - K20 - DC5 - 55MM-
PORTED - ALI EXT - CABLE

DRAWING NUMBER

102-109-00012

SHEET 2 OF 2 A3

UNLESS OTHERWISE STATED:
DIMENSIONS IN MILLIMETRES
TOLERANCES: LINEAR ± 0.1 ANGULAR ± 0.5°
SURFACE FINISH: $\sqrt{\text{V}}$ = $\sqrt{\text{V}}$
DRAWING STANDARDS TO ATQS 6003
DATE FORMAT: DD/MM/YY

THIS DESIGN IS THE PROPERTY OF
S-CAN 3D LTD AND MUST NOT BE
REPRODUCED OR COMMUNICATED
WITHOUT AUTHORITY

CAD PLOT
DO NOT
SCALE