

22  
FROM SIDE OF THROTTLE HOUSING  
TO SIDE OF LEVER ARM

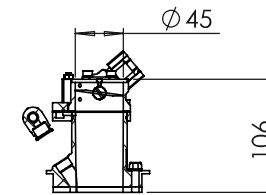

SECTION A-A

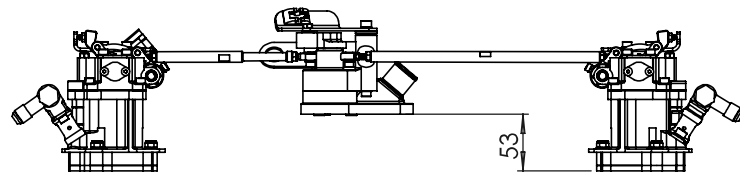
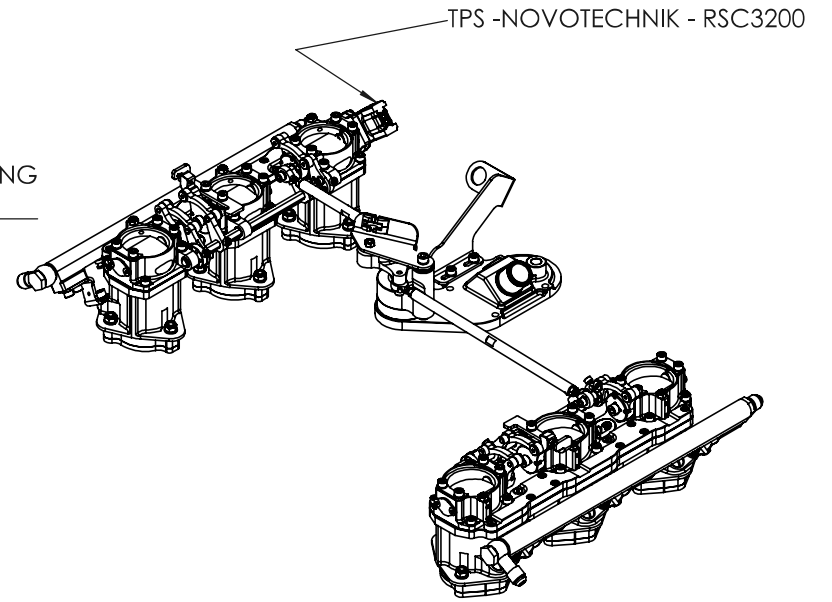

S-CAN 3D Ltd  
Bunns Bank Ind Est  
Atleborough NR17 1QD

UNLESS OTHERWISE STATED:  
DIMENSIONS IN MILLIMETRES  
TOLERANCES: LINEAR  $\pm 0.1$  ANGULAR  $\pm 0.5^\circ$   
SURFACE FINISH  $\checkmark = \checkmark$   
DRAWING STANDARDS TO ATQS 6003  
DATE FORMAT: DD/MM/YY

THIS DESIGN IS THE PROPERTY OF  
S-CAN 3D LTD AND MUST NOT BE  
REPRODUCED OR COMMUNICATED  
WITHOUT AUTHORITY

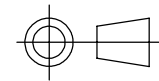

THIRD ANGLE PROJECTION

SCALE 1:5 WEIGHT 5879.681 kg

DRAWN- S.HOW

DATE - 12/05/21

CHECKED - S.HOW

APPROVED - A.CLIFTON

MATERIAL  
SEE COMPONENT PARTS

FINISH  
SEE COMPONENT PARTS

DRAWING TITLE  
PORSCHE 964-993 - 1989-98  
- 44 DIA PORT TO 45 - CABLE

DRAWING NUMBER  
102-102-00273